

**Please, read this manual  
carefully before use!**

**Owner's Manual**



## **Electric Lawn Trimmer**

**KS BCT-1400**

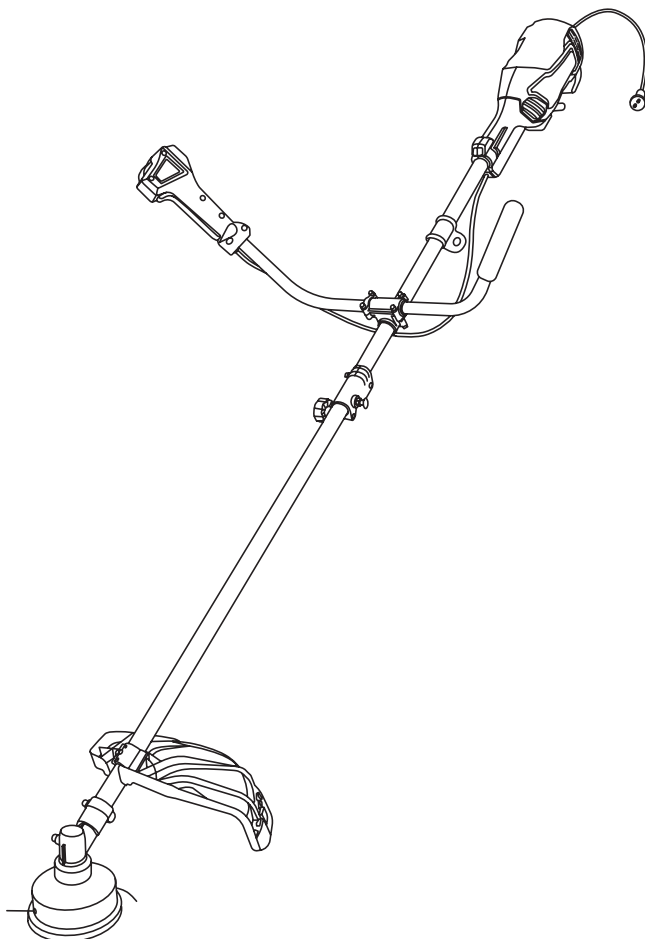



Thank you for opting for **Könnér & Söhnen®** products. This manual contains a brief description of safety, setup and use. More information can be found on the official importer's website in the support section: **konner-sohnen.com/manuals**

You can also go to the support section and download the manual by scanning the QR code or on the website of the official importer of **Könnér & Söhnen®** at **www.konner-sohnen.com**



*Please, read this manual carefully before use!*

The manufacturer of **Könnér & Söhnen®** products reserves the right to make changes that may not be reflected in this manual, namely:

- The manufacturer reserves the right to make changes in the product design, configuration and construction.
- The images and drawings in this manual are for reference only and may differ from the actual components and inscriptions on the products.

Contact information that you are free to use in case of any problems can be found at the end of this manual. All information in this manual is correct to the best of our knowledge and belief at the date of its publication. The current list of service centers can be found on the official importer's website at **www.konner-sohnen.com**



**ATTENTION – DANGER!**



**Failure to follow the recommendations marked with this sign may lead to serious injury or death of the operator or third parties.**



**IMPORTANT!**



**Useful information while operating the machine.**

## SAFETY INSTRUCTION

**1**



**WARNING!**



**Read all instructions failure to follow all instructions listed below may result in electric shock, fire and /or serious injury. The term “power tool” in all of the warnings listed below refers to your mains operated (corded) power tools.**

### WORK AREA

- Keep the work area clean and well lit. Cluttered and dark areas invite accidents
- Do not operate power tools in explosive atmospheres, such as in the presence of flammable liquids, gases or dust. Power tools create sparks, which may ignite the dust or fumes.
- Keep children and bystanders away while operating a power tool. Distractions can cause you to lose control.







### ELECTRICAL SAFETY

- Power tool plugs must match the outlet. Never modify the plug in any way. Do not use any adapter plugs with earthed (grounded) power tools. Unmodified plugs and matching outlets will reduce risk of electric shock.
- Avoid body contact with earthed or grounded surfaces such as pipes, radiators, ranges and refrigerators. There is an increased risk of electric shock if your body is earthed or grounded.
- Do not expose power tools to rain or wet conditions. Water entering a power tool will increase the risk of electric shock.

- Do not abuse the cord. Never use the cord for carrying, pulling or unplugging the power tool. Keep the cord away from heat, oil and sharp edges or moving parts. Damaged or entangled cords increase the risk of electric shock.
- When operating a power tool outdoors, use an extension cord suitable for outdoor use. Use of a cord suitable for outdoor use reduces the risk of electric shock.

### PERSONAL SAFETY

- Stay alert. Watch what you are doing and use common sense when operating a power tool. Do not operate tool when you are tired or under the influence of drugs, alcohol or medication. A moment of inattention while operating power tools may result in serious personal injury.
- Use safety equipment. Always wear eye protection. Safety equipment such as dust mask, non-skid safety shoes, hard hat, or hearing protection used for appropriate conditions will reduce personal injuries.
- Avoid accidental starting. Ensure the switch is in the off position before plugging in. Carrying power tools with your finger on the switch or plugging in power tools that have the switch on invites accidents.
- Remove any adjusting key or wrench before turning the power tool on. A wrench or a key left attached to a rotating part of the power tool may result in personal injury
- Do not overreach. Keep proper footing and balance at all times. This enables better control of the power tool in unexpected situations.
- Dress properly. Do not wear loose clothing or jewelry. Keep your hair, clothing and gloves away from moving parts. Loose clothes, jewelry or long hair can be caught in moving parts.

	Guarantee sound power level.
	Do not expose to rain and humidity.
	Beware of falling objects. Keep bystanders away.
	Caution: If the electrical cable is damaged, please immediately switch off the power supply.
	Keep bystanders at least 15 m away.
	Wear personal protective equipment. Basically, wear protective goggles or, even better, face protection, ear protection, safety helmet, cut-protection working clothes, cut-protection safety boots with anti-slip soles.

### INTENDED USE

This machine can be used with the cutting wire as a trimmer for cutting grass and weeds. Any other use or modification of this machine is prohibited and involves high risks.

### MAIN OVERVIEW

2



**IMPORTANT!**



**Manufacturer reserves the right to make changes and/or improvements in design, components set and technical attributes without notice and without incurring obligation. The pictures in this manual are schematic and may not match the parameters of original product.**

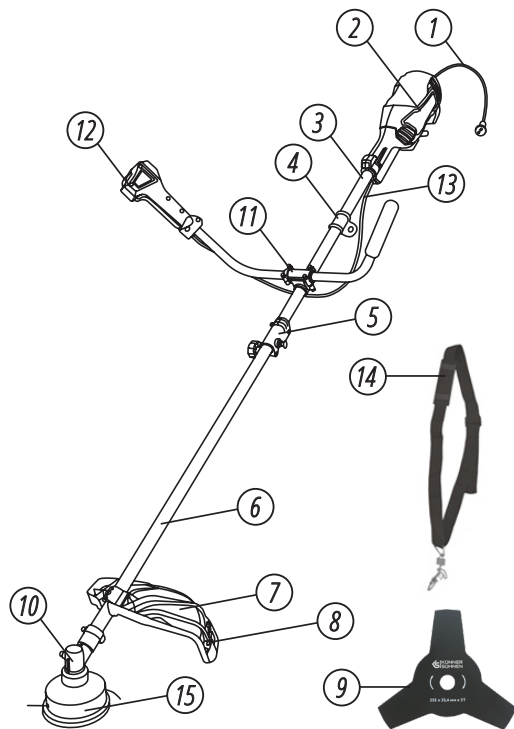

1. Supply cable
2. Motor
3. Upper tube shaft
4. Harness support
5. Connector
6. Lower tube shaft
7. Carter of protection
8. Wire cutting line
9. Metal cutting blade
10. Angle drive
11. Handlebar support
12. Handle and handle with switch on/off and switch-lock release button
13. Electrical wiring
14. Harness
15. Cutting head

### PACKAGE CONTENT LIST

- Brush cutter
- Protecting guard
- Harness
- Cutting disc
- Spool
- Socket wrench
- Hex spanner

## SPECIFICATIONS

3

Model	KS BCT-1400
Power	1400 Watts
Voltage	230V~50Hz
Speed (brushcutter)	7500 /min
Cutting diameter (brushcutter)	255 mm
Thickness cutting (brushcutter)	1,4 mm
Speed (grass trimmer)	7000 /min
Cutting diameter (grass trimmer)	420 mm
Cutting thickness (grass trimmer)	1,6 mm
Gross dimensions (L×W×H)	940×260×130 mm
Gross/Net weight	5,6/4,5 kg

Guarantee sound power level – L<sub>wa</sub> = 96 dB(A)

Vibrations – 4,421 m/s<sup>2</sup> K= 1,5 m/s<sup>2</sup>

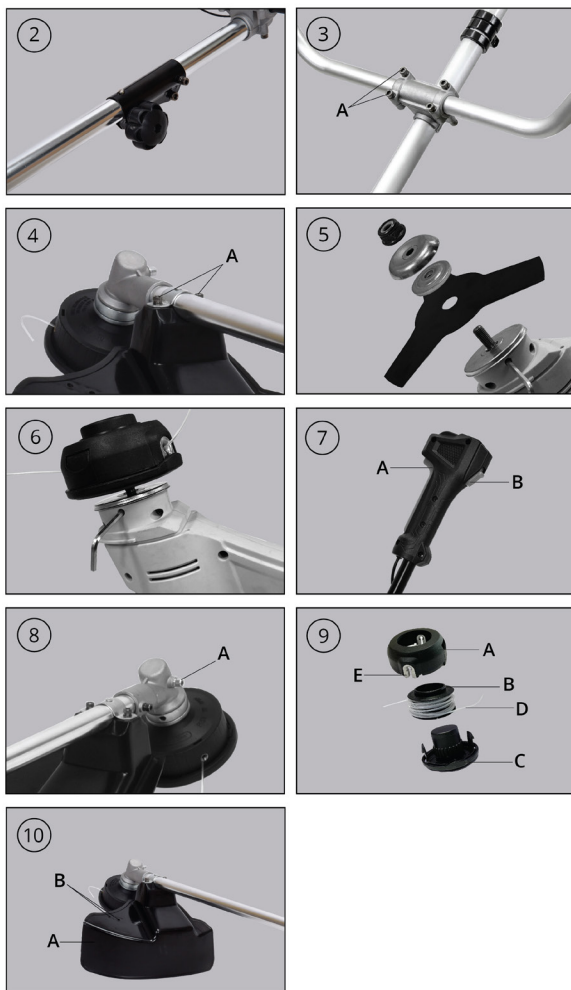

**WARNING!**



Before working on the device, disconnect it from the power supply. Use only original parts and be careful when assembling the brushcutter. Risk of injury! Before working, you must mount the safety guard on the cutting device, and the two tubes. Assemble the tool as explained below and use the pictures above.

### MOUNTING THE TWO TUBES OF THE SHAFT (FIG 2)

1. Push the two parts of the tubular shaft together (hole at the top of the bottom tube); you will hear a click.
2. Put and tighten the screw cap in the correct direction.
3. Before starting the machine, check that the lower tube is firmly installed and secured. Before starting the machine, make sure that the rod of the tube is closed and secure and that it is in the correct position.

### DISMANTLING

To disassemble, proceed in the reverse direction of 8.1, Lift the cover plate, press the locking tab and remove the lower tube.

### **MOUNTING THE HANDLEBAR (FIG 3)**

1. Loosen the 4 Allen screws (A) on the upper tube and remove the handlebar bracket.
2. Insert the handlebar onto the bracket; tighten it with the bracket and the 4 Allen screws (as shown).
3. Secure the wiring with the large clip to the upper tube and a smaller clip on the multifunction handle. Make sure the wiring is not bent or broken.

### **MOUNTING THE CARTER OF PROTECTION (FIG 4)**

Place the protective cover on the shaft. Screw the Allen screws as shown.

### **MOUNTING THE METAL CUTTING BLADE (FIG 5)**

When working with the metal cutting blade, wear gloves.

1. On the shaft, insert in the following order:
2. Tool drive, metal cutting blade, drive washer, cover bell and the holding nut.
3. Secure the shaft by inserting a metal rod on the side of the drive gear and on the tool drive. Tighten the retaining nut counterclockwise with the supplied wrench.

### **DISASSEMBLY:**

Insert a metal shaft locking pin into the hole on the side of the drive gear and on the tool drive.

Loosen the retaining nut clockwise with the wrench and remove the cover bell, the drive washer and the metal cutting blade.

### **MOUNTING THE WIRE CUTTER HEAD (FIG 6)**

1. Add the tool drive on the spindle. Add and screw the wire head manually counterclockwise as shown (block the drive shaft rotation with the inserted rod).
2. Never use the brush head without the plastic housing.

### **DISASSEMBLY:**

Manually remove the wire head. Secure the drive shaft with the metal rod inserted in Fig 6.

### **HARNESS ATTACHMENT**

To work with the device, always wear it with the harness. Before removing the harness, always turn off the appliance. There is a risk of injury.

1. Attach the harness
2. Adjust the length of the shoulder strap with the belt to 10 cm under the hips.

## **OPERATION**

## **5**

### **OPERATING THE BRUSH MACHINE**

Do not use the device without the carter of protection. Before each use, make sure that the appliance is functional. Make sure the power supply matches the safety label. When working with the electric brush cutter, always wear protective equipment.

Protect yourself from noise and comply with local regulations.

### **SWITCH ON / OFF (FIG 7)**

1. Connect the appliance to the power supply.  
Be sure to stand upright and hold the device firmly with both hands. Do not place the cutting head on the floor.
2. To switch on, press the lock with the right thumb (B) and press or release the switch (A). Release the lock.
3. To stop, release the M / A button (A). Switching for continuous operation is not possible. After turning the unit off, the head continues to run for several seconds. The M / A switch must not be locked  
When released, the engine must stop. If the switch is damaged, do not continue working with the machine.

### **EXTENSION OF THE WIRE IN NYLON**

Your device is equipped with a two-wire automatic extension, tap the button of the wire head on the ground, brush cutter on, the wires will come out automatically. The length of the wires will be adjusted automatically by the cutting blade on the safety guard.



**WARNING!**



**Regularly clean the wire knife to ensure proper cutting.**

If the cutting power is reduced, turn the appliance on and hold it above the grass. Touch the floor with the head. The wires are automatically extended.

**When the end of the wire is less than 2.5 cm:**

- Switch off the appliance and disconnect it
- press the coil to lock it and pull the remaining wire strongly
- too short wires do not have enough centrifugal force to lengthen automatically

**If you do not see the end of the thread:**

- Replace the cutting head (see chapter Maintenance and cleaning).

**CUTTING INSTRUCTIONS**

- Always wear appropriate harness and protective clothing during use.
- When starting or working, make sure that the cutting head does not touch any stone, gravel, wire or other foreign matter.
- During use, avoid too much effort on the equipment.
- Avoid contact with fixed objects (rock, wall, fence, batten, etc.). Use the crankcase edge to maintain the correct distance.
- Do not run over the cable with the machine running. This can cause damage. The cable must remain on the back of the user.
- Start the unit before approaching the lawn.
- Begin mowing from the electrical connection, do not approach the cutting head of the electric wire and work away from it.
- Cut the tall grass in several stages from top to bottom.
- Do not cut damp or wet grass.

**WORKING WITH THE CUTTING HEAD**

- Short or worn wires cut badly. If there is an inefficient cut, check if there is any wire remaining in the coil. Read the paragraph Wire extension.
- During use, hold the cutting head just above the floor at all times and gently rotate the unit. Cut gently and keep the machine tilted about 30 ° forward.

**WORKING WITH THE METAL BLADE**

Make sure the blade is properly mounted. Replace damaged or blunt blades. There is a risk of injury!

- Blades cut only free surfaces. Inspect the area thoroughly and remove any foreign matter. Avoid impacts with stones, metal or other obstacles. The blades could be damaged and there is a risk of retro-shock.
- Inspect the damaged blades regularly and replace if necessary.
- Do not use the appliance to cut rejects or thickets.
- During use, hold the head above the floor and rotate the appliance like a regular left and right arc.
- Do not hold the cutting head tilted.

## MAINTENANCE AND STORAGE

**6**

Before working on the appliance, unplug it.

**MAINTENANCE OF ANGLE RETURN**

Before each use, check and add, if necessary, the grease for the angle drive (Fig 8A).

Remove the screw on the side of the return housing.

## REPLACING THE CUTTING HEAD (FIGURE 9)

1. Disconnect the power supply.
2. Turn the appliance upwards to raise the head.
3. The coil housing and the coil are inserted only. To open, remove the cover (A) from the cover (C). Remove the coil (B).
4. The coil is supported by a spring, on either side of the spring there is a washer (top and bottom).
5. To reload coil D with wire, pull the wires through the eyelets (E) of the housing. Hold the wires in the eyelets (E) of the reel housing. Push the reel into the housing. Pull the two wires. Check that the resorts are properly installed. Replace the spool cover.
6. Press and hold the knob (D) and pull the thread sufficiently past the automatic thread cutter.

## REPLACING THE BLADE (FIGURE 10)

Check the blade.

1. Loosen the fastenings screws (B) and remove the blade (A).
2. Place a new knife and secure it with a screwdriver.

## CLEANING

- Clean and maintain the appliance regularly. This will ensure performance and durability.
- After each use, remove the grass and soil from the brush cutter and the safety guard.
- Keep the ventilation slots clean and free of grass.
- Clean the appliance with a soft brush or cloth.

Do not spray water on the appliance or soak it in water. Do not use detergent or solvent. The device would be irreparably damaged. Chemicals can attack the plastic parts of the device.

## SERVICE AND SPARE PARTS

Have your appliance checked by qualified personnel using original parts. This will ensure the safety of the tool. If you require technical advice, repairs or genuine parts, contact the K&S service nearest you. For information or places of service, go to: [www.koenner-soehnen.com](http://www.koenner-soehnen.com)

When ordering spare parts, please indicate the part number.

## STORAGE

- Clean your appliance and its accessories after each use. This prevents the formation of clusters.
- Store the device in a dry place away from dust and out of reach of children.
- Do not store the unit in direct sunlight.
- Do not place the appliance in plastic bags as mildew may appear.
- Do not place the unit under a protective cover. Hang it on a wall with the top of the handle. Make sure the cover does not touch anything. Otherwise, there is the risk of crankcase deformation and thus a change of the safety characteristics.

## DISPOSAL

7



Electrical products should not be discarded with household products. According to the European Directive 2012/19/EC on waste electrical and electronic equipment and its implementation into national law, electrical products used must be collected separately and disposed of at collection points provided for this purpose. Talk with your local authorities or dealer for advice on recycling.



The international manufacturer warranty is 1 year. The warranty period starts from the date of purchase. In cases when warranty period is longer than 1 year according to local legislation please contact your local dealer. The Seller which sells the product is responsible for granting the warranty. Please contact the Seller for warranty. Within the warranty period, if the product fails because of defects in the production process, it will be exchanged on the same product or repaired.

All faults caused by the manufacturer during the warranty period will be eliminated free of charge. Warranty repair is carried out only if you have a fully completed warranty card, the Buyer's signature of acceptance of the warranty terms, as well as a document supporting the purchase (cash receipt, sales slip or invoice). In the absence thereof, as well as in the event of errors or corrections not authenticated by the seller's seal or illegible inscriptions in the warranty card or tear-off coupon, no warranty repair is carried out, no objections to quality are accepted and the warranty card is withdrawn by the service center as invalid. The device is accepted for repair clean and full.



# EC Declaration of Conformity

Nr. 177

The following products have been tested by us with the listed standards and found in compliance with the European Community Directive 2014/30/EU relating to electromagnetic compatibility, Directive 2006/42/EC relating to machinery.

Manufacturer: DIMAX INTERNATIONAL GmbH  
Address: Flinger Broich 203, 40235 Duesseldorf, Germany  
Product: Electric brush cutter and string trimmer "Könner & Söhnen"  
Type / Model: KS BCT-1400

The statement is based on a single evaluation of above mentioned products. It does not imply an assessment of the whole production and does not permit the use of the test lab. logo. The manufacturer should ensure that all product in series production are in conformity with the product sample detailed in this report. The applicant should hold the whole technical report at disposal of the competent all the right.

Applied EC Directives: 2014/30/EU Electromagnetic compatibility Directive (EMC)  
2006/42/EC Machinery Directive

Applied Standards: EN 60335-1:2012/A15:2021  
EN ISO 11806-1:2022  
EN 50636-2-91:2014  
EN 62233:2008  
IEC 50335-1:2010, COR1:2010, COR2:2011, AMD1:2013,  
COR1:2014, AMD2:2016, COR1:2016  
EN ICE 55014-1:2021  
EN IEC 55014-2:2021  
EN IEC 61000-3-2:2019/A1:2021  
EN IEC 61000-3-3:2013/A2:2021

## 2000/14/EC\_2005/88/EC Annex VI

For model KS BCT-1400 Noise measured Lwa = 93 dB (A), guaranteed Lwa = 96 dB (A)



**Issued Date:** 2024-01-15  
**Place of issue:** Duesseldorf  
**Director:** Fomin P.

**DIMAX**  
International GmbH  
Flinger Broich 203 40235 Düsseldorf  
USt-ID DE296177274  
koenner-soehnen.com

*P. Fomin*

We DIMAX INTERNATIONAL GmbH hereby declare that specified above conforms covering European Parliament and Council Directives, 2006/42/EC of 17 May 2006 Machinery Directive, Electromagnetic compatibility Directive (EMC) 2014/30/EC of 26 February 2014. The CE mark above can be used under the responsibility of manufacturer. After completion of an EC declaration of Conformity and compliance with all relevant EC directives.

## CONTACTS

### Deutschland:

DIMAX International GmbH  
Flinger Broich 203 -FortunaPark-  
40235 Düsseldorf, Deutschland  
[www.koenner-soehnen.com](http://www.koenner-soehnen.com)

### Ihre Bestellungen

[orders@dimaxgroup.de](mailto:orders@dimaxgroup.de)

### Kundendienst, technische Fragen und Unterstützung

[support@dimaxgroup.de](mailto:support@dimaxgroup.de)

### Garantie, Reparatur und Service

[service@dimaxgroup.de](mailto:service@dimaxgroup.de)

### Sonstiges

[info@dimaxgroup.de](mailto:info@dimaxgroup.de)

---

### Polska:

DIMAX International  
Poland Sp.z o.o.

Polska, Warszawska,  
306B 05-082 Stare Babice,  
[info.pl@dimaxgroup.de](mailto:info.pl@dimaxgroup.de)

---

### Україна:

ТОВ «Техно Трейд КС»,  
вул. Електротехнічна 47, 02222,  
м. Київ, Україна

[sales@ks-power.com.ua](mailto:sales@ks-power.com.ua)

---