

**Please, read this manual
carefully before use!**

Owner's Manual



Car vacuum cleaner

KS VC20

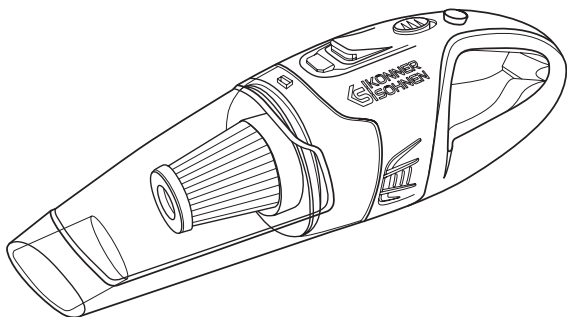



Thank you for opting for **Könner & Söhnen®** products. This manual contains a brief description of safety, setup and use. More information can be found on the official importer's website in the support section: **konner-sohnen.com/manuals**

You can also go to the support section and download the manual by scanning the QR code or on the website of the official importer of **Könner & Söhnen®** at **uk.konner-sohnen.com**



Please, read this manual carefully before use!

The manufacturer of **Könner & Söhnen®** products reserves the right to make changes that may not be reflected in this manual, namely:

- The manufacturer reserves the right to make changes in the product design, configuration and construction.
- The images and drawings in this manual are for reference only and may differ from the actual components and inscriptions on the products.

Contact information that you are free to use in case of any problems can be found at the end of this manual. All information in this manual is correct to the best of our knowledge and belief at the date of its publication. The current list of service centers can be found on the official importer's website at **uk.konner-sohnen.com**



ATTENTION - DANGER!



Failure to follow the recommendations marked with this sign may lead to serious injury of the operator or third parties.



IMPORTANT!



Useful information while operating the machine.

PRODUCT DESCRIPTION

1

This product is a special vehicle vacuum with high-efficient filtration system and unique quick dust cleaning design. It's simple and convenient and won't get your hands dirty. The vacuum can rapidly and efficiently clean up any small particles and dry life debris in the car.

DIRECTIONS

2

1. Keep the suction inlet flat on the floor to achieve better effect. Change suction inlet according to different use.
2. Please turn off the machine after use.

SAFETY INSTRUCTION

3

1. Please operate the product strictly according to the instructions under normal conditions.
2. Don't let the vacuum work without monitoring.
3. Do not vacuum clean the following items to prevent the risk of fire, personal injury, or damage to the vacuum cleaner:
 - Hot objects such as cigarette butts, charcoal fire, etc.;
 - Sharp fragments such as broken glass, etc.;
 - Corrosive solvents or liquor;
 - Flammable and explosive materials such as petrol or alcohol products.
4. Remember not to immerse the vacuum machine into water and avoid approaching the hot items or direct exposure to the sun to prevent the fire caused by short circuit.
5. The device must not be stored at temperatures exceeding 60 °C.
6. Never do anything that may cause mechanical damage to the device.
7. Do not disassemble or transform the product without authorization.
8. Don't let children play with the vacuum cleaner to avoid an accident.
9. The appliance requires no lubrication or user maintenance other than emptying the dust container. The electronic and mechanical part of the vacuum cleaner was factory sealed. Any attempt to tamper with the casing of the vacuum cleaner may cause damage to the vacuum cleaner.

MAIN OVERVIEW

4



IMPORTANT!



Manufacturer reserves the right to make changes and/or improvements in design, components set and technical attributes without notice and without incurring obligation. The pictures in this manual are schematical and may not match the parameters of original product.

1. Inlet port
2. Transparent ductbin
3. HEPA (high efficiency particulate air filter) filtration system
4. Dustbin release button
5. LED light
6. Main power switch
7. LED light switch
8. Vent

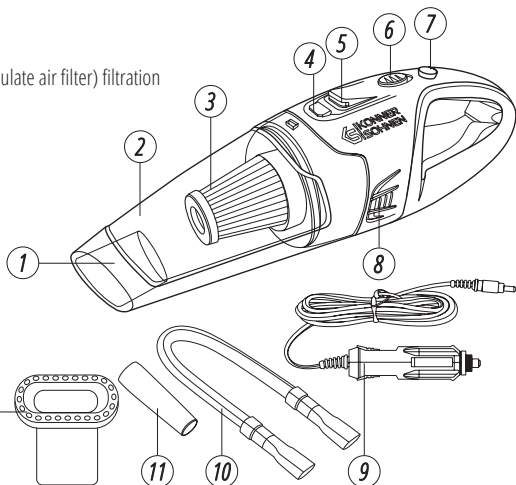

THE PACKAGE INCLUDES:

9. Power cord with a 12 V car cigarette lighter plug
10. Extension hose
11. Crevice tool
12. Brush nozzle

TECHNICAL SPECIFICATION

5

Model	KS VC20
Rated voltage	DC 12 V
Rated power	120 W
Vacuum degree	8000 Pa
Cable length	3 m
Dimensions (LxWxH)	415×125×135 mm
Gross weight	1.3 kg
Accessories	1×Power cord with a 12 V car cigarette lighter plug, 1×Manual, 1×Extension hose, 1×Crevice tool, 1×Brush nozzle

MAINTENANCE

6

1. Regularly clean the trash inside the dust box to prevent malfunction of the vacuum cleaner.
2. Please don't wipe the surface of the vacuum with petrol or oily matter, which should be cleaned with water or neutral detergent. And the cotton cloth should be wrung up when you wipe the product to keep water from the electronic component inside the vacuum cleaner.

3. In case of reduced suction power or after prolonged use, clean the dust container and the HEPA filter element of the vacuum cleaner regularly to ensure perfect cleaning results.



WARNING!



Using filters without drying may damage the motor!

MAINTAINING THE HEPA FILTER:

The HEPA filter is a high-performance reusable filter element that requires gentle handling during operation and cleaning. Special care should be taken to ensure its structural integrity to prevent deformation and deterioration of its soft corrugated part. You can choose your preferred cleaning method from the listed below, but be sure to remove it from the vacuum cleaner before cleaning.

MECHANICAL DRY CLEANING:

- Remove dirt and dust on the outside using a new paint brush;
- Purge the inside with compressed air in the opposite direction of suction.

RINSING IN RUNNING WATER

- Carefully rinse the inside of the filter with plenty of clean running water so as not to deform the soft corrugated part, and let the filter dry completely before using it again.

POSSIBLE FAILURES AND SOLUTIONS

7

Fault	Possible Cause	Solution
The vacuum cleaner completely stops working	The switch is not turned on or is not energized.	Make sure the switch is turned on and energized.
Decreasing suction	Excessive dust on the filter.	Clean the dust inside the dust cup and filter.



EC Declaration of Conformity

Nr. 164

The following products have been tested by us with the listed standards and found in compliance with the European Community Electromagnetic compatibility Directive (EMC) 2014/30/EC.

Manufacturer: DIMAX INTERNATIONAL GmbH
Address: Flinger Broich 203, 40235 Duesseldorf, Germany
Product: Car vacuum cleaner "Könner & Söhnen"
Type / Model: KS VC20

The statement is based on a single evaluation of above mentioned products. It does not imply an assessment of the whole production and does not permit the use of the test lab. logo. The manufacturer should ensure that all product in series production are in conformity with the product sample detailed in this report. The applicant should hold the whole technical report at disposal of the competent all the right.

Applied EC Directives: 2014/30/EU Electromagnetic compatibility Directive (EMC)

Applied Standards: EN 55014-1:2017/A11:2020,
EN 55014-2:2015



Issued Date:
Place of issue:
General director:

2023-10-01
Duesseldorf
Fomin P.

P. Fomin

DIMAX
International
GmbH
Steuer-Nr: 103 5722 2493
Umsatz-Nr: DE296177274

We DIMAX INTERNATIONAL GmbH hereby declare that specified above conforms covering European Parliament and Council Directives, Electromagnetic compatibility Directive (EMC) 2014/30/EC of 26 February 2014. The CE mark above can be used under the responsibility of manufacturer. After completion of an EC declaration of Conformity and compliance with all relevant EC directives.

CONTACTS

Deutschland:

DIMAX International GmbH Flinger
Broich 203 -FortunaPark- 40235
Düsseldorf, Deutschland

www.koenner-soehnen.com

Ihre Bestellungen

orders@dimaxgroup.de

**Kundendienst, technische Fragen und
Unterstützung**

support@dimaxgroup.de

Garantie, Reparatur und Service

service@dimaxgroup.de

Sonstiges

info@dimaxgroup.de

The United Kingdom:

Innovation Trade Ltd.,
63/66 Hatton Garden Fifth Floor,
Suite 23, London, EC1N 8LE

info.uk@dimaxgroup.de

Technical support

support.uk@dimaxgroup.de

Polska:

DIMAX International
Poland Sp.z o.o.

Polska, Warczawska,
306B 05-082 Stare Babice,
info.pl@dimaxgroup.de

Україна:

ТОВ «Техно Трейд КС»,
вул. Електротехнічна 47,
02222, м. Київ, Україна

sales@ks-power.com.ua